

FTS-200H3 Telescoping Channel

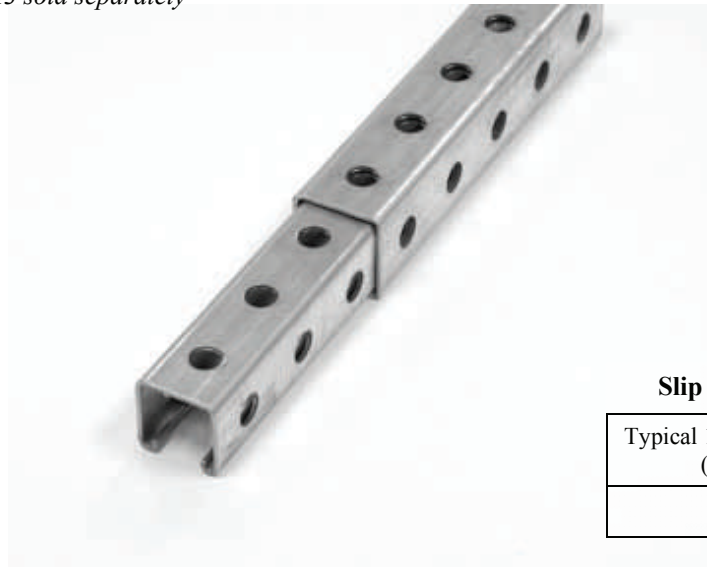

2900 Commonwealth Ave NE
Warren, OH 44483
(800) 397-8788
Fax (330) 372-3666
www.flexstrut.com

FTS-200H3 and FS-200H3 sold separately



Slip Load Resistance (Safety Factor = 3)

Typical 1/4" thick 2-hole fitting with (2) 1/2" bolts and nuts	700 lbs
1/2" bolt and nut	3600 lbs

Standard Finish: Pre-galvanized (PG)
Standard Length: 10 ft · 20 ft

FTS-200H3

Telescoping Strut (1-7/8" x 1-7/8" 12 gauge channel —
fits over 1-5/8" x 1-5/8" channels 9/16" holes on 1-7/8" centers)

Section Properties*		X-X Axis			Y-Y Axis		
Weight lbs/ft	Area In ²	I _x In ⁴	S _x In ³	r _x In	I _y In ⁴	S _y In ³	r _y In
1.93	0.458	0.253	0.253	0.743	0.276	0.294	0.776

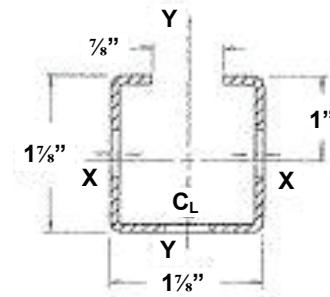

FS-200H3

3-Hole Strut (1-5/8" x 1-5/8" 12 gauge channel
with 9/16" holes on 1-7/8" centers on three sides)

Section Properties*		X-X Axis			Y-Y Axis		
Weight lbs/ft	Area	I _x In ⁴	S _x In ³	r _x In	I _y In ⁴	S _y In ³	r _y In
1.66	0.386	0.160	0.194	0.640	0.172	0.212	0.664

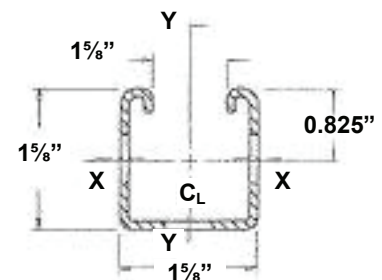

FTS-200H3 and FS-200H3 (combination)

1-5/8" x 1-5/8" 12 gauge channel with 9/16" holes on 1-7/8" centers on three sides

Section Properties*		X-X Axis			Y-Y Axis		
Weight lbs/ft	Area	I _x In ⁴	S _x In ³	r _x In	I _y In ⁴	S _y In ³	r _y In
3.60	0.847	0.413	0.422	0.698	.0448	0.477	0.727

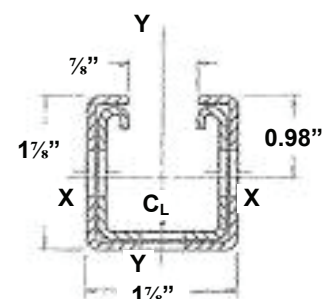

*Section properties are based on nominal metal thickness and overall dimensions.

Beam Loading Data



2900 Commonwealth Ave NE
 Warren, OH 44483
 (800) 397-8788
 Fax (330) 372-3666
www.flexstrut.com

FTS-200H3

Beam Span (inches)	Beam Load Data x-x Axis		
	Allowable Load (lbs)	Resulting Deflection (inches)	Allowable Load @ Deflection = 1/240 Span
12	4203	0.012	4203
24	2099	0.050	2099
36	1396	0.112	1396
48	1044	0.200	1044
60	831	0.312	664
72	689	0.450	456
84	587	0.612	330
96	510	0.799	248
108	450	1.012	190
120	401	1.249	149



FS-200H3

Beam Span (inches)	Beam Load Data x-x Axis		
	Allowable Load (lbs)	Resulting Deflection (inches)	Allowable Load @ Deflection = 1/240 Span
12	2225	0.015	3225
24	1610	0.061	1610
36	1071	0.136	1071
48	800	0.243	658
60	637	0.379	417
72	528	0.546	286
84	449	0.743	206
96	390	0.970	153
108	344	1.228	116
120	306	1.516	90



FTS-200H3 and FS-200H3 (both pieces equal length)

Beam Span (inches)	Beam Load Data x-x Axis		
	Allowable Load (lbs)	Resulting Deflection (inches)	Allowable Load @ Deflection = 1/240 Span
12	7033	0.013	7033
24	3511	0.051	3511
36	2335	0.115	2335
48	1745	0.205	1705
60	1389	0.320	1082
72	1151	0.460	742
84	980	0.627	536
96	851	0.819	401
108	749	1.036	307
120	668	1.279	239

